

Tempest ActiveCool™

Now, from Tempest, closed circuit active cooling for larger, heat-sensitive laser-phosphor video projectors used outdoors.

Tempest ActiveCool™ will keep your projector running within a narrow constant temperature range, in any climate.

ActiveCool operation is completely automatic — just set the target temperature and leave the rest to Tempest's patented DEC4 control system. As soon as DEC4 senses the projector is active, cooled air starts circulating through the enclosure, regulated by the cooler control. The optional Salt Fog protection kit protects the cooler from

corrosive air conditions by the beach or shipboard. The large protective filter cowl also protects against windblown sand and dust in desert conditions.

The cooler is isolated from the projector enclosure to prevent condenser vibration transmitting to the beam. An anti-vibration mounting kit is available and recommended when ActiveCool is mounted on the same base as the projector enclosure, especially for long throw applications.

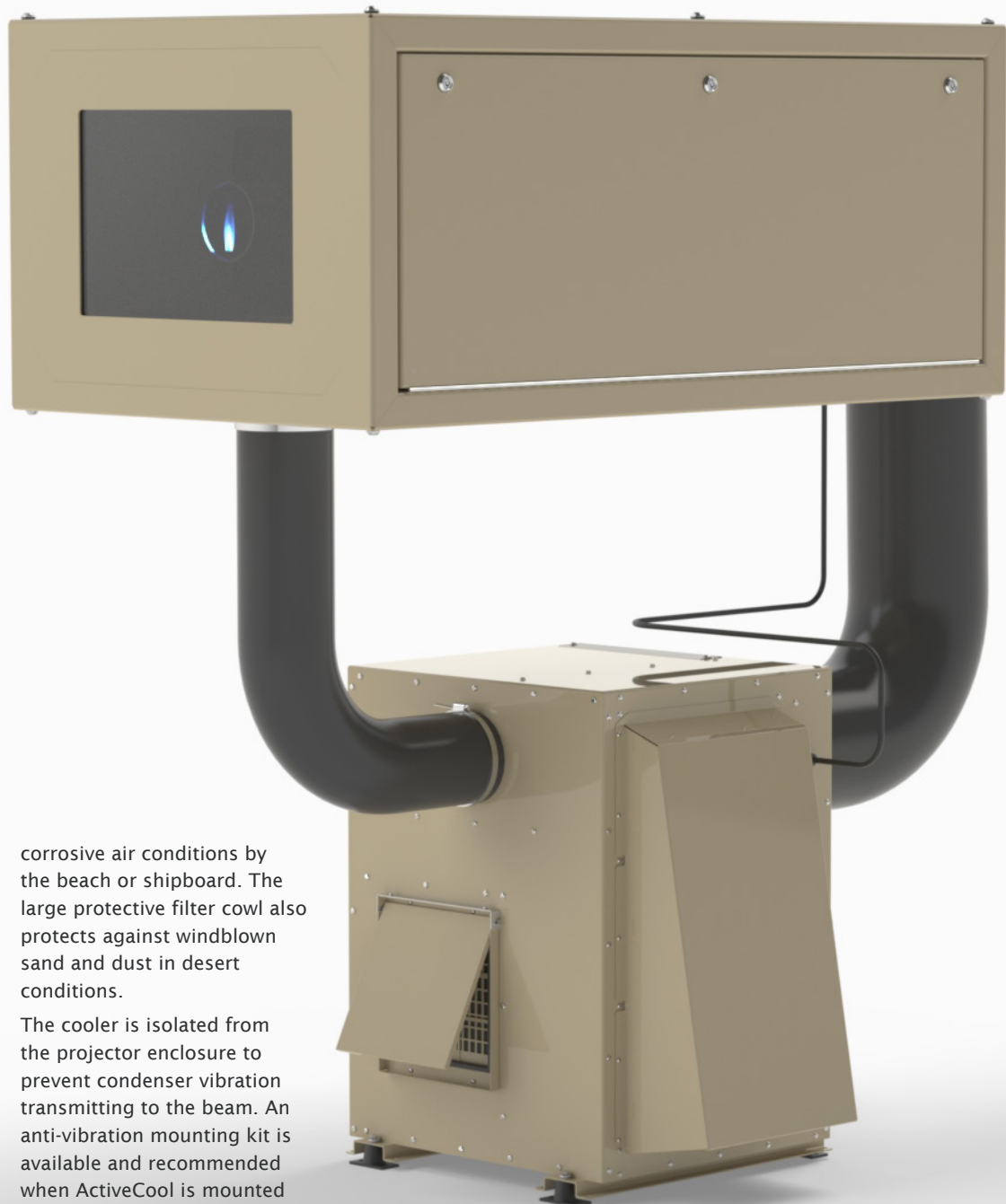

Dimensions (with Salt Fog Kit and Anti-Vibration Kit)

Weight: 252lb, 115kg
 Air Hose: max length 10'/3m

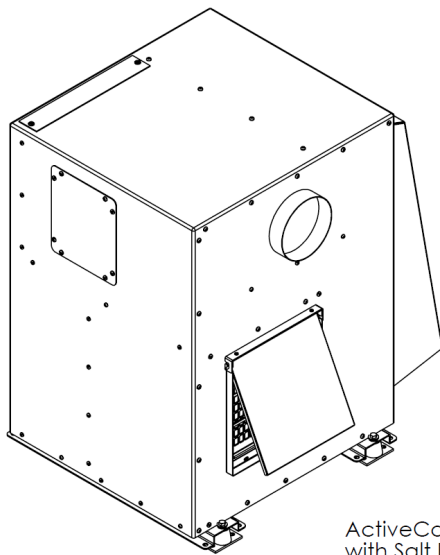
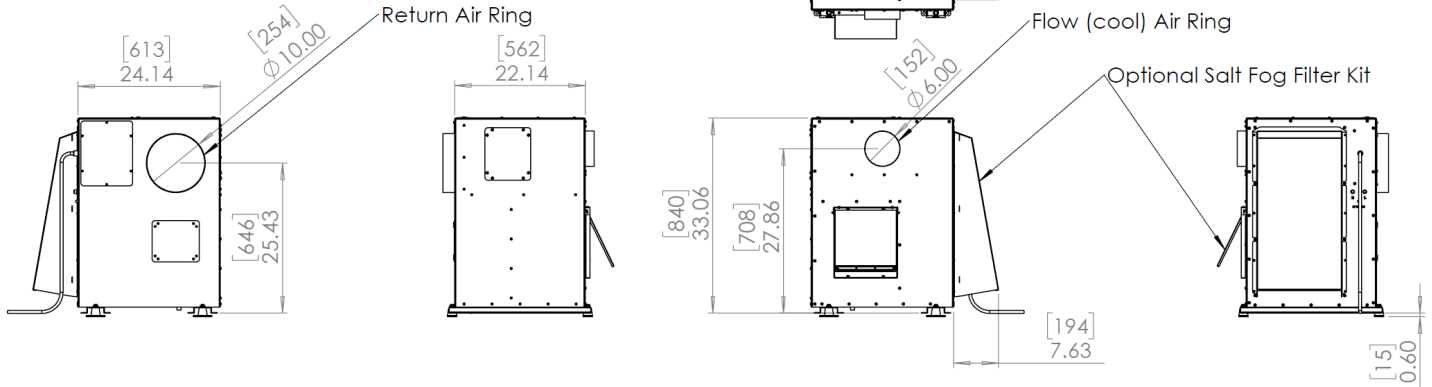

ActiveCool cooler, with Salt Fog Kit and Anti-vibration Feet

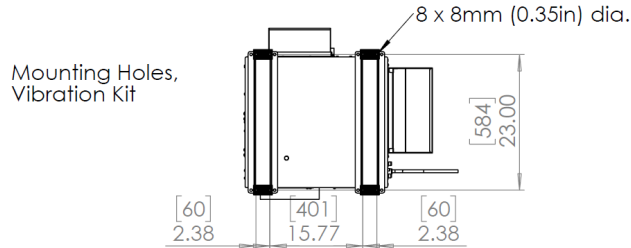

Mounting Holes, Vibration Kit

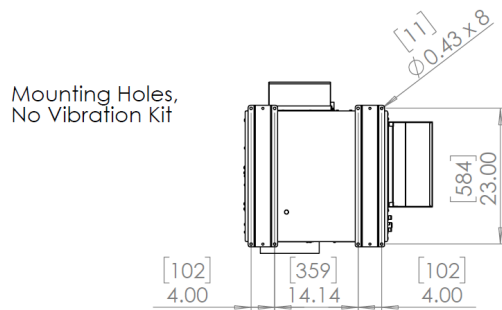

Mounting Holes, No Vibration Kit

Electrical

AC55.50

Voltage: 200-250VAC, 50Hz
 Power: 1,800W

AC55.60

Voltage: 200-250VAC, 60Hz
 Power: 1,800W

Connections

There are three connections between the ActiveCool cooler and the Cyclone enclosure:

Power: outdoor rated Neutrik PowerCon True1 TOP power outlet — simply plug the cooler in to the Cyclone enclosure and operation is automatic.

Cool Air Flow: a 150mm (6") hose connects to the enclosure inlet port.

Warm Air Return: a 250mm (10") hose connects to the fan-assisted enclosure exhaust port.

See Tempest [Cyclone User Manual](#) for more details.

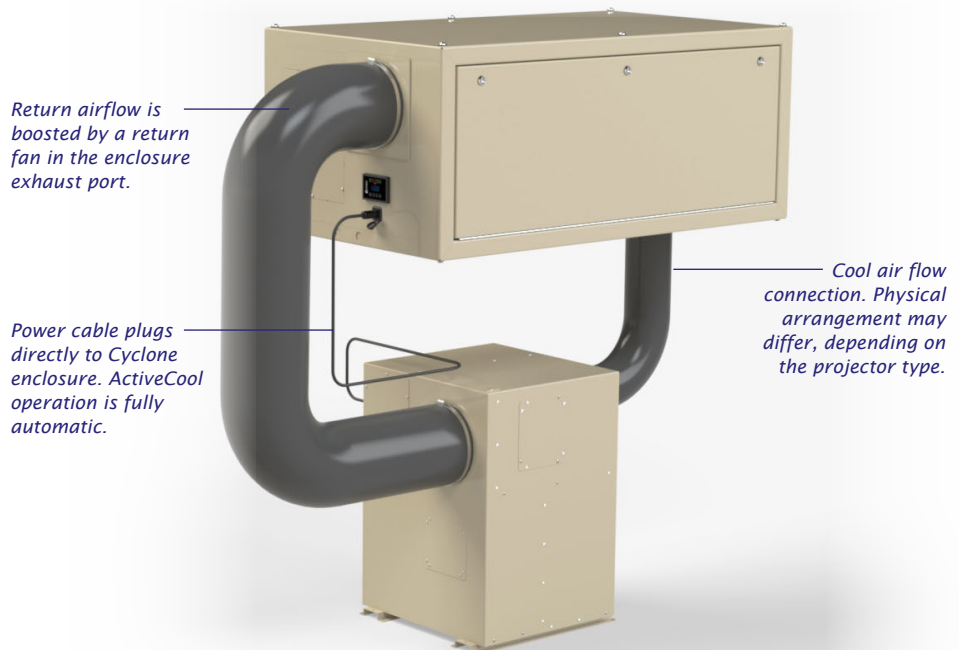

Ordering Information

AC55.50

ActiveCool System for Cyclone enclosure, for 50Hz power, including connecting hoses, cables, and Cyclone control and connectors

AC55.60

ActiveCool System for Cyclone enclosure, for 60Hz power, including connecting hoses, cables, and Cyclone control and connectors

AC55.SF

ActiveCool Salt Fog Filter Kit, with salt fog filter, inlet cowl and exhaust flap protection

51.HF.32AC

Replacement ActiveCool Salt Fog filter

AC55.VM

ActiveCool Anti-Vibration Mounting Kit. Recommended when the ActiveCool unit and projector enclosure are mounted on the same concrete pad or structural frame, especially in long-throw applications.

Suitable Projectors

For use with projectors with thermal dissipation in the range 10—14,000btu, including:

- Barco UDX, XDL
- Christie Crimson
- Christie D4K40-RGB
- Christie Gryffin
- Epson L25-30,000
- Panasonic PT-RZ21K
- Panasonic PT-RZ31K, PT-RZ50K

See Tempest Cyclone brochure for suitable enclosure models.

Contact Tempest if you don't see your projector on this list.



ActiveCool Cooler, with optional Anti-Vibration Mounting Kit, connected to Cyclone 55.324 Enclosure, for Christie D4K40-RGB.

Note: connections between cooler and enclosure may vary, depending on projector type.



 Made in the USA

©Tempest Lighting, Inc., March 2021

In the interest of continuous product improvement, specifications are subject to change without notice

Tempest Lighting, Inc

11845 Wicks Street, Sun Valley, CA 91352, USA

www.tempest.biz info@tempest.biz

t: +1 818 787 8984 f: +1 818 982 5510